

i-Kiosk 100

ENCLOSURE INSTALLATION DIAGRAM

- 1 Position the wall plate properly on top of the mounting plate; tighten the bolts and nuts to join these two plates together securely.
- 2 Position the mounting plate that has been attached to the wall plate, and the terminal to the enclosure; tighten the screws to secure them on the enclosure.
- 3 Mount the enclosure on a wall or a surface and tighten the screws to secure its position.
- 4 Hang the terminal on the wall plate, tighten the 2 screws at the bottom of the terminal.
- 5 Make sure that the enclosure has been mounted firmly by tightening all the screws.

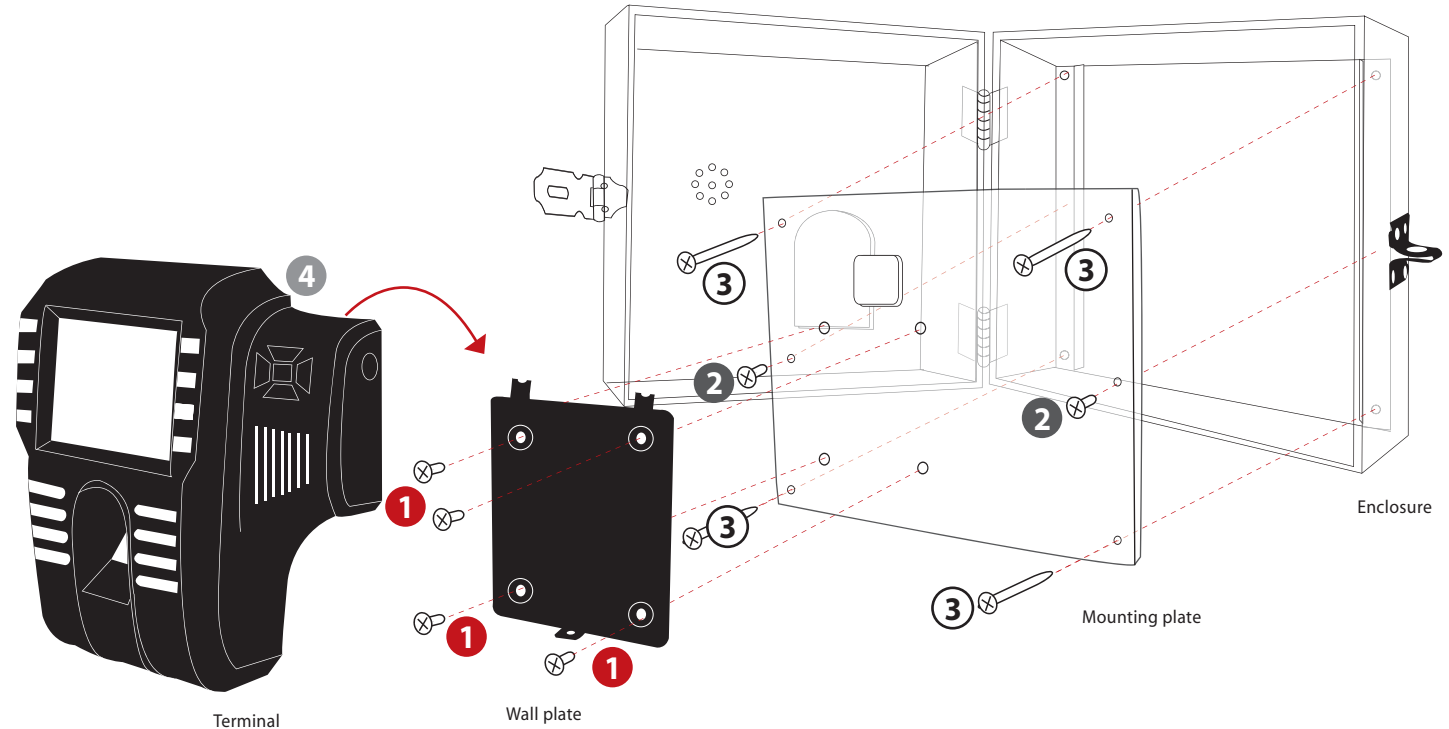

Note:

INSTALLATION OF ENCLOSURE WITH ACCESS CONTROL MODELS

Before you start with step no. 1 above, make sure that all the terminal's wires are put through the enclosure, back plate and wall plate, and all the wires are connected to the terminal's port correctly.